

# GSG3-125系列隔离开关

## GSG3-125 Series Separated Switch

### ——配电器产品名录 2013

安全 智能 环保



CE UL CCC TÜV CB RoHS  
ISO9001 ISO14001 OHSAS18001

# GSG3-125系列隔离开关

## >> 用途 APPLICATION

GSG3-125系列隔离开关主要在配电网中作为电源总开关，其在合闸状态下，能可靠地通过正常的工作电流和在规定的时间内承载规定的故障电流，以保证用电的持续性；而在分闸状态下，其有可靠的绝缘间隙，使用电设备和线路与电源隔离，以保证用电设备免受过电压损害和保障检修工作的安全。该隔离开关可左装辅助触头，对电路提供辅助控制。

GSG3-125 series separated switch mainly use in the electricity-distribution networks as power main switch, when it in switching-on status, it can reliably pass normal working current as well as bear specified faulty current within specified time, in order to ensure persistence of electricity; while in switching-off status, it can provide reliable insulating gap to make electricity-consumer equipment as well as circuit to be isolated with power supply, and to prevent the electricity-consumer equipments from being damaged due to over voltage and also ensure safety maintenance working. The separated switch can be left installation auxiliary contact, provide auxiliary control to the circuit.

## >> 采用标准及认证情况 ADOPT STANDARD AND AUTHENTICATION SITUATION

- 本系列产品符合标准IEC60947-3、GB14048.3;  
The range of products conform to the standard IEC60947-3、GB14048.3;
- 获得CCC认证和TUV认证;  
Acquired CCC certification and TUV certification;

## >> 型号及含义 MODEL AND MEANING

### ■ 型号及含义 TYPE AND MEANING

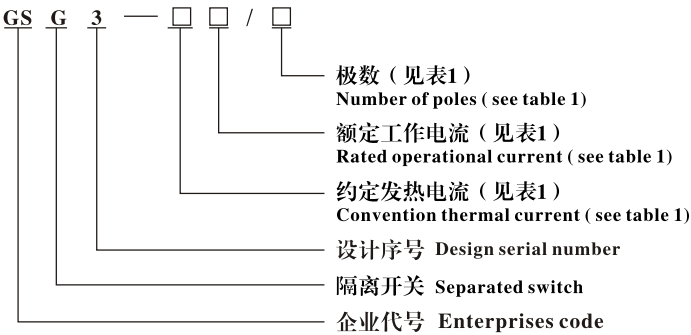

表Table 1

型 号 Type	极 数 Pole	约定发热电流 Convention thermal current	额定工作电流 Rated operational current
GSG3-125	1P、2P、3P、4P	125A	63A、100A、125A



## >> 工作条件和安装条件

### WORKING CONDITION AND INSTALLATION CONDITION

- △ 环境温度：-5℃ ~ +40℃，且24内的平均温度不超过+35℃；  
Environment temperature: -5℃ ~ +40℃， and average temperature not exceeding +35℃ within 24 hours;
- △ 海拔高度：不超过2000m；  
Elevation: not exceed 2000m;
- △ 环境条件：应无会引起爆炸危险的介质，也无腐蚀和破坏绝缘的有害气体和导电尘埃；  
Environmental conditions: There should be no cause explosive medium, no corrosion and damage insulation harmful gas and conductive dust;
- △ 冲击和振动：应安装和使用在无明显冲击和振动的地方；  
Impact and vibration: should be installed and used in have no obvious impact and vibration places;
- △ 安装类别：安装类别Ⅲ； Installation category: installation category Ⅲ;
- △ 安装条件：采用TH35-7.5卡轨安装； Installation conditions: mounted by TH35-7.5 rail track;
- △ 接线方式：采用带螺钉的接线端子方式； Mode of connection: with screw terminals;
- △ 使用类别：AC-22A Use category: AC-22A

## >> 主要性能参数 MAIN PERFORMANCE PARAMETER

项 目 Item	性 能 Performance	备 注 Remark
频 率 Frequency	50/60HZ	
额定绝缘电压 Rated insulation voltage	415V	
额定工作电压 Rated operational voltage	240/415V	
约定发热电流 Convention thermal current	125A	
额定工作电流 Rated operational current	63、100、125A	
额定短时耐受电流 Rated short-time withstand current	16Ie	耐受时间1s Tolerance time 1s
额定短路接通能力 Rated short circuit making capacity	30Ie	通电时间 $t \geq 0.1s$ Making time $t \geq 0.1s$
额定接通能力 Rated making capacity	3Ie	
额定分断能力 Rated breaking capacity	3Ie	
有载操作次数 Load operating times	2000次	
空载操作次数 No-load operation times	10000次	
极数P Number of poles P	1、2、3、4	

# GSG3-125系列隔离开关

## >> 产品特点 PRODUCT FEATURES

- △ 卡簧式安装，更方便快捷；**Snap spring type installation, more convenient and quick;**
- △ 手柄采用滚花及弧形表面设计，使操作更舒适；  
**Hand shank use knurling and curved surface design, make the operation more comfortable;**
- △ 产品表面流线型设计，使外形更美观；  
**Product surface streamline design, make appearance more beautiful;**
- △ 优良的选材，提高了绝缘性能和承载能力，使产品安全、可靠；  
**Excellent material, improve insulation performance and bearing capacity, make the product safety and reliable;**
- △ 采用隧道式接线方式，可接6~50mm<sup>2</sup>导线，使接线更可靠。  
**Using tunnel connection mode, can pick up 6~50 mm<sup>2</sup> wire, make the connection more reliable.**

## >> 外形及安装尺寸（单位：mm） APPEARANCE AND INSTALLATION DIMENSIONS（UNIT: MM）



图 picture 3

型号Type	极数Pole n	a	b	c	d	e	f	g	h
GSG3-125	1、2、3、4	79.8	77.5	18	42	72	45	36.8	20.5
注:n为极数。Note: n for pole									

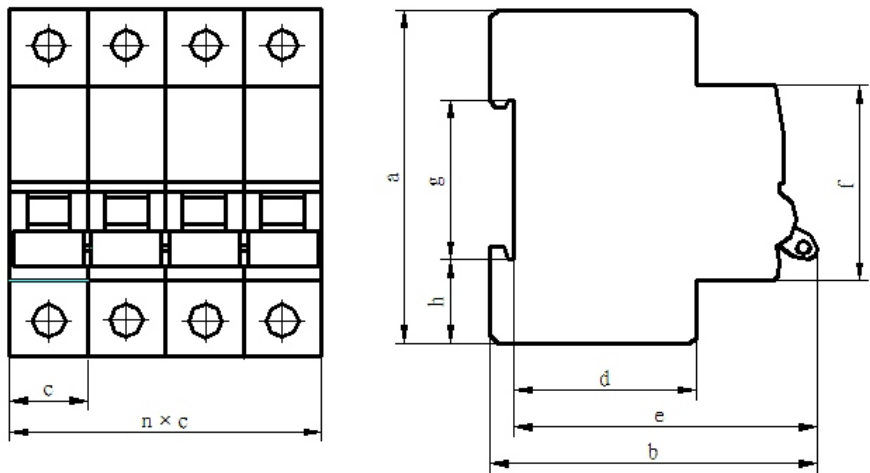

## >> 端子标志 TERMINAL MARKS

■ 隔离开关一极、二极、三极、四极接线端子标志分别如下图所示。

Separated switch one pole, two pole, three pole, four pole terminal marks respectively as below.

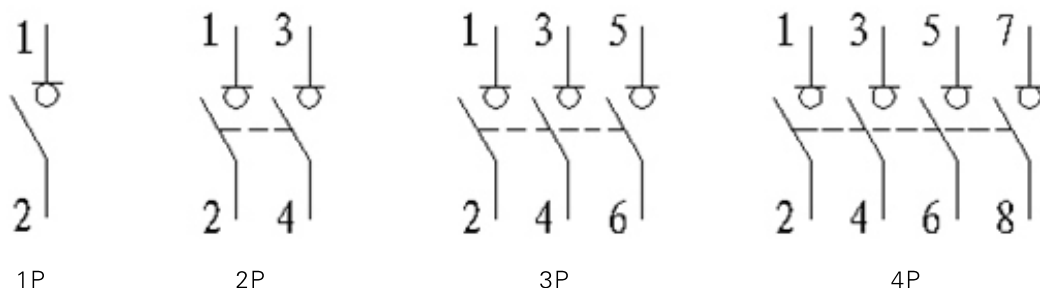

## >> 订货须知 ORDERING INSTRUCTION

■ 用户订货时必须指明隔离开关的名称、型号、规格、数量及附件的名称。

When placing an order must specify name, model, specification, quantity and accessory of separated switch.

△ 如：隔离开关 GSG3-125 63A/3P+OF2 600只

For example: separated switch GSG3-125 63A/3P+OF2 600 sets

△ 表示：GSG3-125系列隔离开关，63A/3P，加装辅助触头，600只。

Show: GSG3-125 range separated switch, 63A/3P, add installation auxiliary contacts, 600 sets.